



TOWN OF EATON PRE-APPLICATION FORM

223 1ST Street, Eaton, CO 80615 • (970) 454-3338 • Fax (970) 454-3339 • www.colorado.gov/townofeaton

COMPLETE ALL BOXES

Applicant Name: <i>Ryan Ross</i>	[REDACTED]
Applicant Phone: [REDACTED]	[REDACTED]
Property Owner Name: <i>Ryan Ross</i>	Property Owner Address & Zip Code: [REDACTED]
Property Owner Phone: <i>same</i>	Property Owner Email: <i>same</i>
Project Name: <i>Russing LLC</i>	Project Description: <i>Commercial building</i>
Project Address/Location:	Project Parcel Number: <i>080306111004</i>
Subdivision/Lot/Block: <i>Eaton Industrial Park lot 4</i>	Section/Township/Range: <i>6 6N 65W</i>
Existing Zoning: <i>Industrial I2</i>	Proposed Zoning: <i>I-2 Industrial</i>
Existing Use: <i>Empty Lot</i>	Proposed Use: <i>Warehouse</i>

APPLICATION AGREEMENT:

I, as the applicant, hereby certify that I believe to the best of my knowledge that all information supplied with this application is true and accurate and that consent of the property owner listed above, without which the requested action cannot lawfully be accomplished, has been granted. Permission is also hereby granted to the Town of Eaton staff and their consultants to physically enter upon and inspect the subject property and take photographs as necessary for preparation of the case. In addition, by signing this application I am agreeing that I am authorized to sign on behalf of the property owner, or business-owner, or applicant and commit and agree to the payment of any and all fees associated with processing this application. In addition, I agree to pay the Town the sum of \$500 to be used to pay the Town's expenses to review, evaluate and process this Pre-Application submittal which funds may be used to pay the cost of third-party consultants (such as Town Planner, Town Engineer, Town Attorney). If the costs exceed the sum of \$500, I agree to pay the Town the difference upon receipt of an invoice from the Town of Eaton for time and materials in excess of \$500. I agree that I am not acquiring any rights by virtue of this application.

Applicant's Signature: [REDACTED]

Date: *1-22-24*

DOCUMENTS REQUIRED FOR PRE-APPLICATION MEETING:

☒ Completed Pre-App Form ☒ Cover Letter ☒ Vicinity Map ☒ Sketch Plan ☒ \$500 Application Fee

FOR TOWN OF EATON USE ONLY:

Received By:

KMUK

Date:

1-26-2024

Fee Collected:

500.00
CK # 1897



Date: January 25, 2024

To Whom It May Concern:

Attached are the requested documents for a new build for Running R.

Please contact me if you need any additional information or if you have any questions.

A handwritten signature in blue ink, appearing to read "Nick Varra". The signature is fluid and cursive, with a long horizontal stroke at the end.

Nick Varra
Varra Buildings INC



1: 633



This map is a user generated static output from an internet mapping site and is for reference only. Data layers that appear on this map may or may not be accurate, current, or otherwise reliable.

THIS MAP IS NOT TO BE USED FOR NAVIGATION

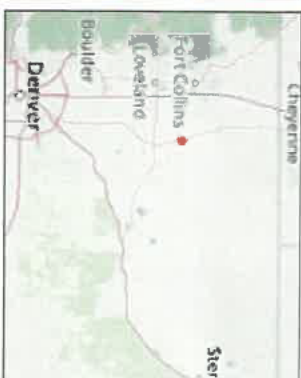

Legend

- Parcels
- Highway
- County Boundary

Notes

40'X104'X16' Post frame building with
24'X32'10' attached office

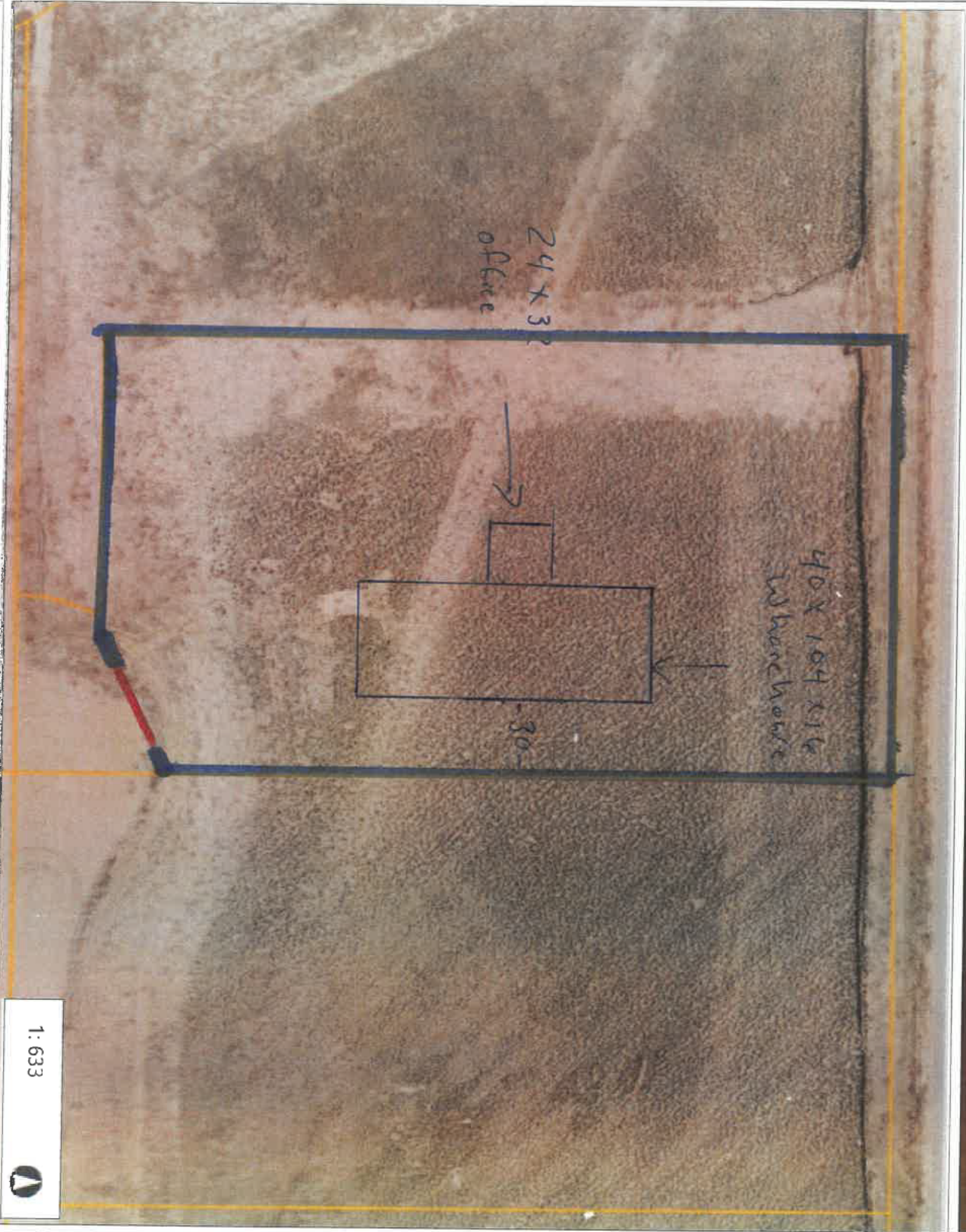

1: 633



Legend

- Parcels
- Highway
- County Boundary

6' Chain
link fence

18" Culvert

Notes

40'X104'X16' Post frame building with
24'X32'10' attached office

This map is a user generated state output from an Internet mapping site and is for
reference only. Data layers that appear on this map may or may not be accurate,
current, or otherwise reliable.

THIS MAP IS NOT TO BE USED FOR NAVIGATION